

$N_{\perp}L$
 220 - 240V

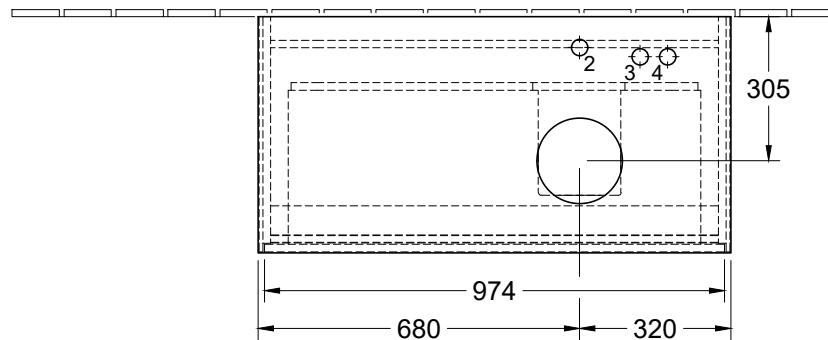

	1	2	3	4	H2	A1
5A25 45/46	X		X	X	1070	620
5A26 60/61	X	X	X	X	1070	630
5A27 60/61	X	X			1070	630
4179 43	X	X	X	X	1045	645
4198 61	X	X	X	X	1045	645
4172 58	X	X	X	X	1045	645
4178 41	X	X		X	1045	645
4A1840	X	X	X	X	1060	650
4A2138	X	X	X	X	1060	650
4A1956	X	X	X	X	1060	650
4A2056	X	X	X	X	1060	650
4143 61	X	X	X	X	1030	620
5148 00/01	X	X	X	X	1025	605
4A45 00/01	X	X	X	X	1035	615
5144 00/01	X	X	X	X	1035	605
4A46 00/01	X	X	X	X	1035	615
5151 00/01	X	X	X	X	1025	605
4A47 00/01	X	X	X	X	1035	615
5151 10/11	X	X		X	1035	605
4A48 00/01	X	X	X	X	1035	615
5154 00/01	X	X	X	X	1025	605
4A49 00/01	X	X	X	X	1035	615
4A50 00/01	X	X			1030	610
4110 60	X	X	X	X	1020	610

Collaro
 C04000XX / C040B0XX

V02 / 27.08.2021

1:16

