



Villeroy & Boch

1748

VICONNECT

The clever connection



THE CLEVER CONNECTION BEHIND THE WALL

ViConnect always provides the right solution behind the wall – for toilets, bidets, urinals and washbasins. The range includes 13 installation systems, which guarantee a reliable installation for all standard installation situations. Especially the WC-elements for wall-mounted and floor-standing back to wall toilets enable with 5 dry-wall and 4 brick-wall construction elements multiple installation solutions



Washbasin element:

- Even large washbasins can be installed securely
- The water connections can be freely positioned
- The trap cover can also be installed with SmartFix
- Suitable for concealed siphons



Toilet elements:

- For all Standard, Compact, XL, Vita and floor-standing toilets
- Perfect for DirectFlush toilets and SupraFix 3.0 attachment
- Simple installation of ViClean shower toilets



Urinal element:

- Connections can be freely adjusted
- Continuously adjustable flushing time
- Compatible with ViChange
- Also available for ProDetect urinals



Bidet elements:

- The additional strut provides perfect support for wall-mounted bidets
- The water connections can be freely positioned
- Suitable for all bidet taps



VICONNECT – PROVEN VILLEROY & BOCH QUALITY

- All products made in Germany.
- Our reliable installation systems are subjected to regular testing in internal trials with both established and new products from Villeroy & Boch.
- The high standard of the Villeroy & Boch installation systems is confirmed by various certificates and endorsements from independent institutes.



THERE IS A 25-YEAR AVAILABILITY GUARANTEE FOR REPLACEMENT PARTS FOR VICONNECT

VICONNECT SPORTS IMPRESSIVE TECHNICAL ADVANTAGES



- Intuitive and fast installation of the flush plate thanks to innovative cable technology with bayonet joint

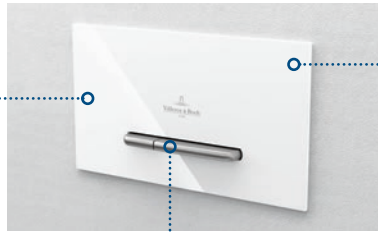

- For M300 and E300 flush plates:
- Intuitive mounting using a magnet technique
 - Surface-mounted as well as flush-mounted
 - Flush-mounted with 1 mm or 5 mm stainless steel frame



VICONNECT PROMOTES SUSTAINABILITY

- All toilet flush plates with 2-volume flush for reduced water consumption
- Flushing volume is easily adjustable (3/4.5l or 3/6l)



- Flexible wall installation allows a wide range of applications (e.g. corner installation)



SupraFix 3.0
Villeroy & Boch

- Integrated vertical struts for safe installation with SupraFix 3.0 and WCs with shortened rear panel
- The waste bend is fully depth-adjustable

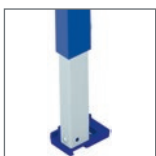

- Height-adjustable, self-locking feet and adjustable base plates



- The flush flow can be readjusted directly via the inspection opening



- Reduced noise flow thanks to tested filling valve and drain fitting

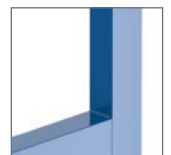

- Durable frame made from powder-coated steel



ViClean
Villeroy & Boch

- Ideal for combination with ViClean shower toilets

EXCLUSIVE DESIGN HIGHLIGHTS FOR INDIVIDUAL BATHROOM DESIGN

The modern flush plates blend perfectly with all bathroom ceramics and furniture fronts from Villeroy & Boch thanks to the different materials and colours. Their timeless design provides plenty of freedom to create individual bathrooms.

M300

The M300 flush plate boasts a purist design, with elegant glass surfaces adding an exclusive touch to any bathroom.

COLOUR VARIATIONS (FLUSH PLATE/PUSH BUTTONS)



Art.-Nr.: 922160-xx
Material: Glass



RB Glass Glossy Black /
Stainless Steel



RA Glass Glossy Grey /
Stainless Steel



RE Glass Glossy White /
Stainless Steel

E300

The E300 comes with 7 different colour combinations, providing the right design for various preferences and requirements.

COLOUR VARIATIONS (FLUSH PLATE/PUSH BUTTONS)



Art.-Nr.: 9221xx-xx
Material: Plastics



69-AN Black Matt /
Chrome Matt



69-D8 Anthracite Matt /
Chrome Matt



69-N5 White Matt /
Chrome Matt



61-68 White /
Chrome



80-68 White /
White



80-61 Chrome /
Chrome



80-68 Chrome Matt /
Chrome Matt

INSTALLATION OPTIONS FOR THE M300/E300

The stainless steel installation set allows the flush plates in the M300 and E300 series to be surface-mounted as well as flush-mounted.



Surface-mounted
(no additional parts required)



Flush-mounted with a stainless steel frame
(1 mm) 922159LC installation set flush-mounted



If required: 922158LC distance frame (5 mm)
for covering uneven tile joints

L200



Art.-Nr.: 921843-RB
Material: Glass & LED

Lighting centrepiece for the bathroom. The flush plate has been finished with an illuminated border, turning it into a true centrepiece in the bathroom. The subtle LED light creates a pleasant atmosphere and functions as a nightlight.

Available in Glass Glossy Black

M200



Art.-Nr.: 922400-xx
Material: Glass

The glass surface of the M200 flush plate makes the toilet area look extremely elegant.

COLOUR VARIATIONS



RB Glass Glossy Black



RA Glass Glossy Grey



RE Glass Glossy White

E200



Art.-Nr.: 922490-xx
Material: Plastics

The modern E200 flush plate features sleek lines and a timeless design.

COLOUR VARIATIONS



61 Chrome



69 Chrome Matt



68 White

E100



Art.-Nr.: 922485-xx
Material: Plastics/Stainless Steel

The E100 model has an impressively large round push surface and a very simple operation.

COLOUR VARIATIONS



61 Chrome



69 Chrome Matt



68 White



LC Stainless Steel

U100



Art.-Nr.: 921944-xx
Material: Plastics

The 3 urinal flush plates blend perfectly with any bathroom style thanks to their sleek design and when combined with the toilet flush plate they give the bathroom a very attractive overall impression.

COLOUR VARIATIONS



61 Chrome



69 Chrome Matt



68 White

VICONNECT DRY-WALL CONSTRUCTION ELEMENTS

WC-ELEMENT FOR DRY-WALL CONSTRUCTION – STANDARD HEIGHT

Depth 135–205 mm. For all wall-mounted WCs (Standard, Compact, Vita, XL), for use with SupraFix 3.0, DirectFlush, ViClean*



MEASUREMENTS (HxWxD):	1120x525x135–205 mm
WEIGHT:	14 kg
ADJUSTMENT RANGE OF FEET:	From unfinished floor level to upper edge of finished floor: 0–200 mm
FASTENING POINTS:	4
OPERATION:	front operated
FLUSH QUANTITY:	3/6l adjustable to 3/4.5l, max. flush quantity 7.5l
CERTIFICATIONS:	EN 14055, WRAS

Art.-Nr. 92246100

COMBI-PACKS 0.NOVO

CONSISTING OF:



- 0.novo DirectFlush-WC 5560-RO
- Toilet seat with QuickRelease and SoftClosing 9M385101
- WC-Element for dry-wall construction, – standard height 92246100
- E 200 flush plate

Art.-Nr. 5660D2
Art.-Nr. 5660D3

with E200 flush plate chrome
with E200 flush plate white

WC-ELEMENT FOR DRY-WALL CONSTRUCTION – FREESTANDING

Depth 165–215 mm. For all wall-mounted WCs (Standard, Compact, Vita, XL), for use with SupraFix 3.0, DirectFlush



MEASUREMENTS (HxWxD):	1120x450x165–215 mm
WEIGHT:	20 kg
ADJUSTMENT RANGE OF FEET:	From unfinished floor level to upper edge of finished floor: 0–200 mm
FASTENING POINTS:	2
OPERATION:	front operated
FLUSH QUANTITY:	3/6l adjustable to 3/4.5l, max. flush quantity 7.5l
CERTIFICATIONS:	EN 14055, NF

Art.-Nr. 92246500

WC-ELEMENT FOR DRY-WALL CONSTRUCTION – LOW

Depth 155–205 mm. For all wall-mounted WCs (Standard, Compact, Vita, XL), for use with SupraFix 3.0, DirectFlush



MEASUREMENTS (HxWxD):	820x525x155–205 mm
WEIGHT:	14,5 kg
ADJUSTMENT RANGE OF FEET:	From unfinished floor level to upper edge of finished floor: 0–200 mm
FASTENING POINTS:	4
OPERATION:	front/top operated
FLUSH QUANTITY:	3/6l adjustable to 3/4.5l, max. flush quantity 7.5l
CERTIFICATIONS:	EN 14055, WRAS

Art.-Nr. 92247500

WC-ELEMENT FOR DRY-WALL CONSTRUCTION – LOW

Depth 155–205 mm. For all wall-mounted WCs (Standard, Compact, Vita, XL), for use with SupraFix 3.0, DirectFlush



MEASUREMENTS (HxWxD):	985x525x155–205 mm
WEIGHT:	14,5 kg
ADJUSTMENT RANGE OF FEET:	From unfinished floor level to upper edge of finished floor: 0–200 mm
FASTENING POINTS:	4
OPERATION:	front/top operated
FLUSH QUANTITY:	3/6l adjustable to 3/4.5l, max. flush quantity 7,5l
CERTIFICATIONS:	EN 14055, WRAS

Art.-Nr. 92247800

WC-ELEMENT FOR DRY-WALL CONSTRUCTION – COMPACT

Depth min. 90 mm. For all wall-mounted WCs (Standard, Compact, Vita, XL), for use with SupraFix 3.0, DirectFlush



MEASUREMENTS (HxWxD):	1185x665x min. 90 mm
WEIGHT:	14 kg
ADJUSTMENT RANGE OF FEET:	From unfinished floor level to upper edge of finished floor: 0–200 mm
FASTENING POINTS:	6
OPERATION:	front operated
FLUSH QUANTITY:	3/6l adjustable to 3/4.5l, max. flush quantity 7.5l
CERTIFICATIONS:	EN 14055, WRAS

Art.-Nr. 92247600

VICONNECT FIXING ELEMENTS FOR HANDLES

WC-SYSTEM FOR DRY-WALL CONSTRUCTION

Depth 55 mm. For assembly to left of WC element 9224 61, 9224 65 and for barrier-free installation of a folding support



MEASUREMENTS (HxWxD):	1150x310x55 mm
WEIGHT:	5,35 kg

Art.-Nr. 92198300

WC-SYSTEM FOR DRY-WALL CONSTRUCTION

Depth 55 mm. For assembly to right of WC element 9224 61, 9224 65 and for barrier-free installation of a folding support



MEASUREMENTS (HxWxD):	1150x310x55 mm
WEIGHT:	5,35 kg

Art.-Nr. 92210900

*Equipped with an empty conduit for the water pipe for ViClean shower toilets

VICONNECT DRY-WALL CONSTRUCTION ELEMENTS

WASHBASIN ELEMENT FOR DRY-WALL CONSTRUCTION

Depth 135–205 mm. Individually adjustable for washbasins and hand-rinse washbasins



MEASUREMENTS (HxWxD): 1120x525x75 mm
 WEIGHT: 8 kg
 ADJUSTMENT RANGE OF FEET: From unfinished floor level to upper edge of finished floor: 0–200 mm
 FASTENING POINTS: 4
 DRINKING WATER CONNECTION: With plywood panel and scaling for free positioning of drinking water pipe wall plates

Art.-Nr. 92214900

BIDET ELEMENT FOR DRY-WALL CONSTRUCTION

Depth 135–205 mm. Individually adjustable for bidets



MEASUREMENTS (HxWxD): 1120x525x100 mm
 WEIGHT: 10,5 kg
 ADJUSTMENT RANGE OF FEET: From unfinished floor level to upper edge of finished floor: 0–200 mm
 FASTENING POINTS: 4
 DRINKING WATER CONNECTION: With plywood panel and scaling for free positioning of drinking water pipe wall plates

Art.-Nr. 92214800

URINAL ELEMENT FOR DRY-WALL CONSTRUCTION

Depth 135–205 mm. Compatible with all Villeroy & Boch urinals thanks to adjustable struts and universal cartridge valve technology



MEASUREMENTS (HxWxD): 1120x525x98 mm
 WEIGHT: 8 kg
 ADJUSTMENT RANGE OF FEET: From unfinished floor level to upper edge of finished floor: 0–200 mm
 FASTENING POINTS: 4
 OPERATION: front operated
 FLUSH QUANTITY: Continuously adjustable flow pressure from 4 s–20 s

Art.-Nr. 92198900

URINAL ELEMENT FOR DRY-WALL CONSTRUCTION

Depth 135–205 mm. Compatible with the Villeroy & Boch ProDetect radar control for urinals



MEASUREMENTS (HxWxD): 1120x525x80 mm
 WEIGHT: 7 kg
 ADJUSTMENT RANGE OF FEET: From unfinished floor level to upper edge of finished floor: 0–200 mm
 FASTENING POINTS: 4
 OPERATION: Electronic urinal flushing control ProDetect

Art.-Nr. 92218500

VICONNECT CONCEALED CISTERNS

CONCEALED CISTERN WITH METAL FRAME

Depth 125 mm. For all wall-mounted WCs (Standard, Compact, Vita, XL) and for floor-standing WCs, back to wall, for use with SupraFix 2.0, DirectFlush



MEASUREMENTS (HxWxD): 781 x 453 x 125 mm
 WEIGHT: 7 kg
 FASTENING POINTS: 6
 OPERATION: front / top operated
 FLUSH QUANTITY: 3/6l adjustable to 3/4.5l, max. flush quantity 7.5l
 CERTIFICATIONS: EN 14055, WRAS

Art.-Nr. 92247900

CONCEALED CISTERN WITH METAL FRAME – COMPACT

Depth 80 mm. For all wall-mounted WCs (Standard, Compact, Vita, XL) and for floor-standing WCs, back to wall, for use with SupraFix 2.0, DirectFlush



MEASUREMENTS (HxWxD): 786 x 650 x 80 mm
 WEIGHT: 6 kg
 FASTENING POINTS: 6
 OPERATION: front operated
 FLUSH QUANTITY: 3/6l adjustable to 3/4.5l, max. flush quantity 7.5l
 CERTIFICATIONS: EN 14055

Art.-Nr. 92248400

CONCEALED CISTERN

Depth 124 mm. For all wall-mounted WCs (Standard, Compact, Vita, XL) and for floor-standing WCs, back to wall, for use with SupraFix 2.0, DirectFlush



MEASUREMENTS (HxWxD): 735 x 528 x 124 mm
 WEIGHT: 3,5 kg
 FASTENING POINTS: 2
 OPERATION: front / top operated
 FLUSH QUANTITY: 3/6l adjustable to 3/4.5l, max. flush quantity 7.5l
 CERTIFICATIONS: EN 14055, WRAS

Art.-Nr. 92248300

CONCEALED CISTERN – COMPACT

Depth 80 mm. For all wall-mounted WCs (Standard, Compact, Vita, XL) and for floor-standing WCs, back to wall, for use with SupraFix 2.0, DirectFlush



MEASUREMENTS (HxWxD): 740–825 x 648 x 80 mm
 WEIGHT: 3,5 kg
 FASTENING POINTS: 4
 OPERATION: front operated
 FLUSH QUANTITY: 3/6l adjustable to 3/4.5l, max. flush quantity 7.5l
 CERTIFICATIONS: EN 14055

Art.-Nr. 92248200

VILLEROY & BOCH

GERMANY

*Villeroy & Boch AG
Bathroom and Wellness Division
Corporate Headquarters
66693 Mettlach*

Your sales consultant:

